

# Hihippo ADAPTER INSTALLATION INSTRUCTION

Please install as following if your fauect is male thread(outer thread)

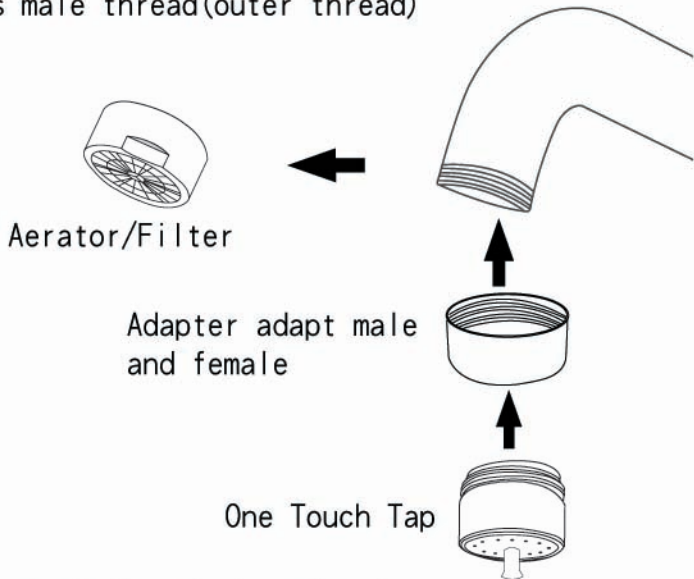

Installation instruction :

1. Turn off the switch.
2. Take off the original aerator/filter with a wrench , then install adapter.
3. Screw one touch tap on tightly and the faucet can be used after turning on the switch.

安裝的龍頭是外牙，請照下列方式安裝...



起泡器

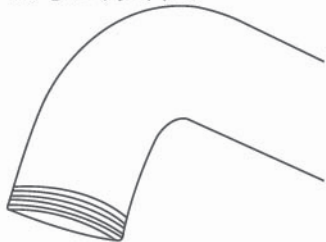

內外牙轉接座



觸控式龍頭開關



## 安裝說明

1. 關水
2. 用扳手把龍頭上原有的起泡器卸下，裝上內外牙轉接座
3. 把觸控式龍頭開關鎖上內外牙轉接座並旋緊，打開水即可使用